

UK Series Decora Face Plates

Shuttered UK Series Decora Flat Face Plates

Infinique’s UK Series Decora Face Plate are aesthetically designed to provide a fresh look to match today’s office decor. These face plates are of UK Standards (85 x 85 mm) and are designed to accept one or two Infinique keystone jacks. Face plates include pressure-release designation label cover for quick and tool-less removal and they come with mounting screws. They are made of flame retardant polycarbonate material, providing extra durability, safety and a aesthetic look for stylish interior design.

UK Series Decora Face Plates are packed in individual easy tear bags with labels, transparent cover and fixing screws.



Product Features

- UK Standard flat and shuttered face plate
- Designed to accept all Infinique Keystone Jacks
- Pressure release designation label cover
- Ensures patch cord accessibility and reduces bending
- Comes standard with all mounting and fixing hardware
- Flame retardant polycarbonate material for extra durability
- Aesthetic design for stylish interiors
- Available in single and dual ports
- Pressure release designation label covers
- Standard color available is White
- Metallic finish and custom colors available for projects

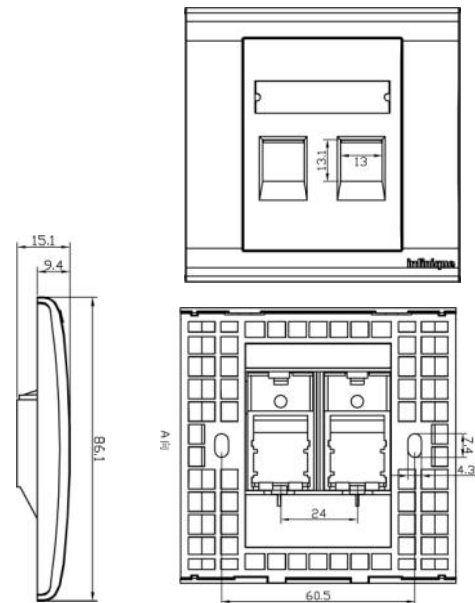

ORDERING INFORMATION

Part Number	Description
INFP186D	Infinique UK Series Decora Face Plate, Flat Shuttered, Single Port
INFP286D	Infinique UK Series Decora Face Plate, Flat Shuttered, Dual Port

Delivery: Face Plate, Fixing Screws, Labels, Transparent Cover in poly bag.

Packaging: Bag=1 Face Plate | Carton=25 Face Plates.